

PREPARED BY:  
DEPARTMENT OF  
DEVELOPMENT SERVICES

# CITY OF POMPANO BEACH

## Painted Pompano Series - Location Map

1 inch = 951 feet



**Annie Adderly Gillis Park**  
**601 Dr. Martin Luther King Jr Blvd**

**Ali Building (rear of property by parking lot)  
/ 353 Dr. Martin Luther King Jr. Blvd**

**McNab Park**  
**2250 E Atlantic Blvd\**

**Beach Library**  
**3250 NE 2nd Street\**

**Fire Station**  
**109 N Ocean Blvd**

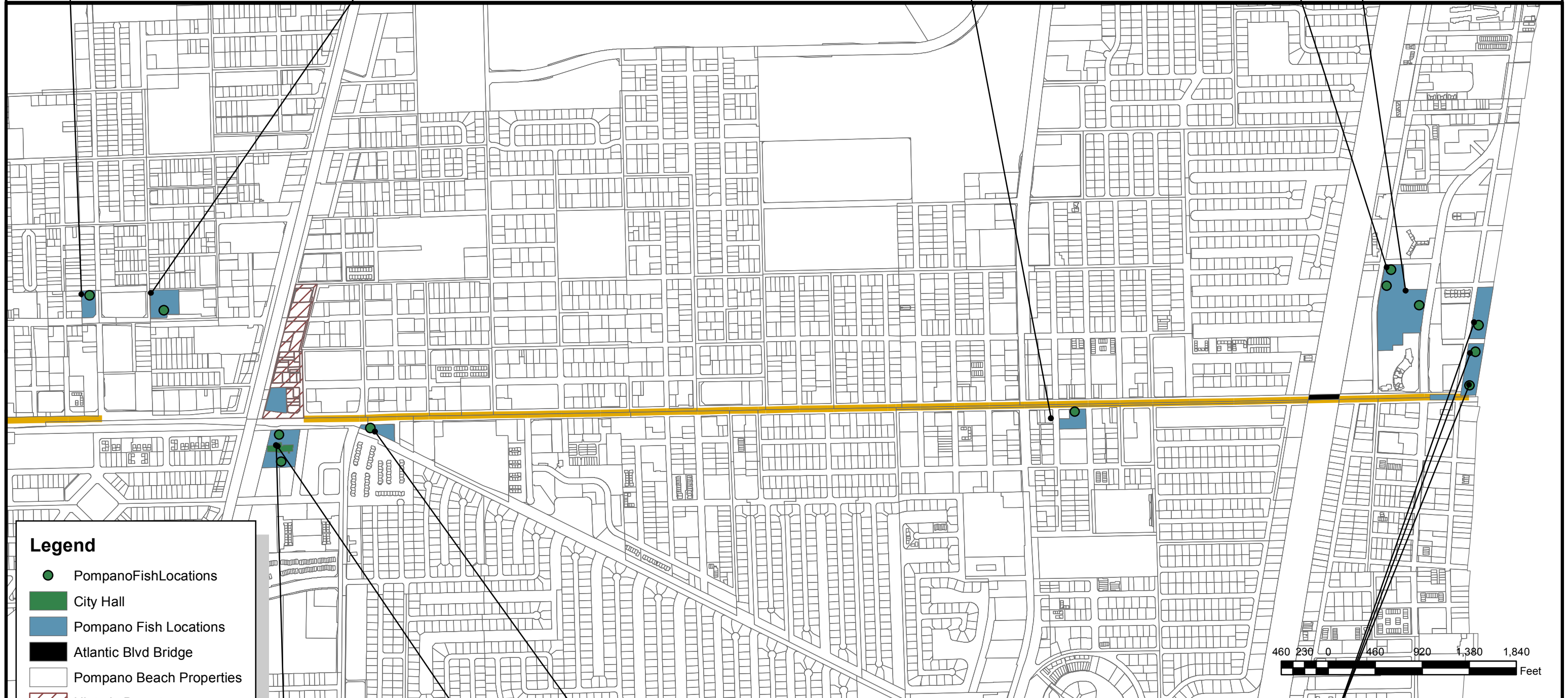

### Legend

- PompanoFishLocations
- City Hall
- Pompano Fish Locations
- Atlantic Blvd Bridge
- Pompano Beach Properties
- Historic Downtown
- AtlanticBlvd

**City Hall**  
**100 W Atlantic Blvd**

**\*\*City Hall**

**220 E Atlantic Blvd Park**

**Beach Plaza**  
**10-12 N Pompano Beach Blvd**

\*\*One of the City Hall fish will be moved to the Plaza/ Old Pompano Historic Area when construction is complete.